

# Series 107-70 Nylon Extractor

CONNECT AND PROTECT

## Series 107-70 Latching Nylon Inserter / Extractor

### MATERIALS AND FINISH

#### Extractor

Molded in Glass Filled (30%) 6/6 or Type 6 Nylon. Main handle is UL94-V0, but latch is UL94-V2.

#### Assembly Pin

Stainless steel, passivated

### COLOR

Series 107-70 standard color is black. Other colors available, please contact an Application Engineer with your requirements.

### HOT STAMPING

Hot stamp marking service is available.  
Please contact an Application Engineer with your requirements.

### APPLICATION DATA

Two inserter or inserter-extractors are recommended per printed circuit board taller than 127 (5) in height.

#### Detail of Actuating Surfaces

Required on Top and Bottom guide plates

Provides insertion and extraction travel of 8.9 (.35) min.

Nominal position of card edge when seated in connector. The inserter-extractor can move the board an additional 1.3 (.050) if necessary due to the tolerances of the assembly

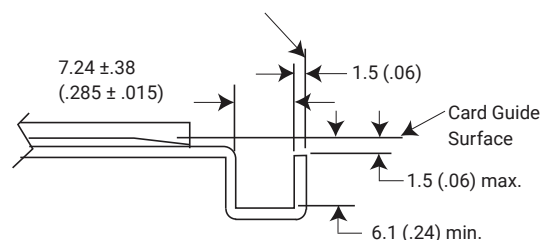

Units: mm (in)  
**Unless otherwise specified:**  
.xx ± .25, .x ± .5  
(.xxx ± .010, .xx ± .02)

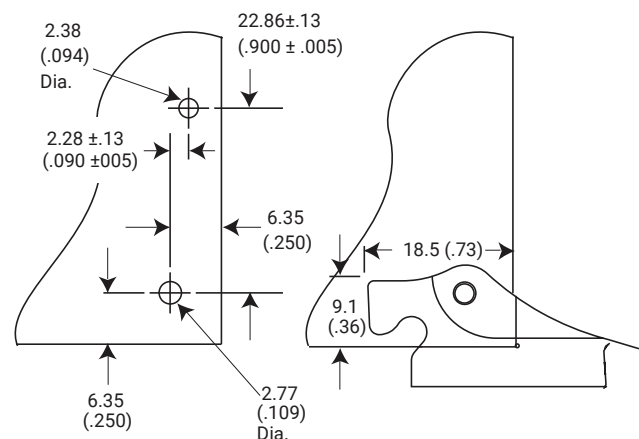
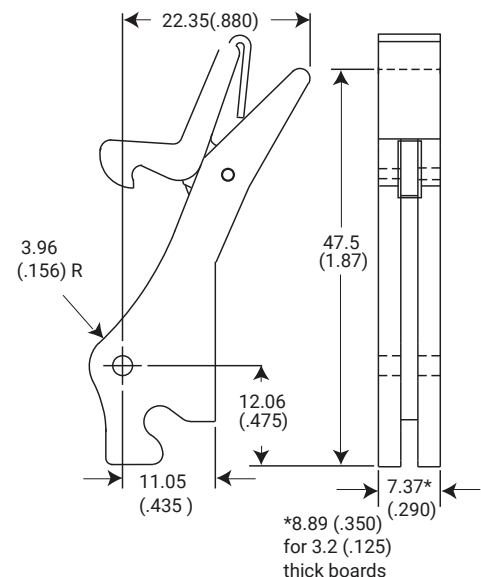

## ASSEMBLY PIN

Option to be pre-started for:

- Faster and easier installation of the extractor to the PCB
- Eliminates the need for special tools or equipment and set up time
- Eliminates loss of loose assembly pins

If the "P" option is not selected, the extractors and the pins will be packaged separately.

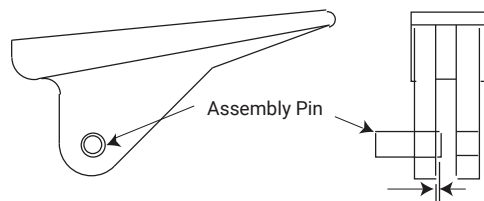

2.38 (.094) dia x 6.35 (.250) long for PCB thickness 1.6 (.063) and 2.4 (0.94)

2.38 (.094) dia x 7.95 (.313) long for PCB thickness 3.2 (.125)

Pin protrusion of approximately .38 (.015) seeks hole in PCB

### Part Number Code

**Series 107-70 Inserter/Extractor**

P 107-70-3

### Assembly Pin

Loose \_\_\_\_\_ [blank]

Pre assembled \_\_\_\_\_ P

### PCB Thickness

1.6 (.063) \_\_\_\_\_ [blank]

2.4 (.094) \_\_\_\_\_ 3

3.2 (.125) \_\_\_\_\_ 4

### Part Number Code example: PC107-70-3

Series 107-70 extractor, with pre-started assembly pin, for PCB thickness of 2.4 (.094)

## nVent SCHROFF, Inc.

7328 Trade Street  
San Diego, CA 92121 USA  
+1 800-525-4682

CALMARK™



Our powerful portfolio of brands:

CADDY ERICO HOFFMAN RAYCHEM SCHROFF TRACER